

JAY V. MCGOVERN

CERTIFIED PETROLEUM GEOLOGIST No. 1170

4226 Petronila Creek, Corpus Christi, TX 78410

Mobile: (361)537-2394 Email: jay@tjmcgovern.com

McGovCo, LLC – 4 new Leased Prospects in South Texas

All subsurface control prospects

- 1) -Location: Bee County (West Berkow Prospect), Frio Formation
-Depth: 5,500'
-Potential Reserves: 4.2 MMBO & 1.5 BCFG
- 2) -Location: Bee County (Tynan Field Prospect), Frio Formation
-Depth: 4,750'
-Potential Reserves: 2.2 MMBO & 4.5 BCFG
- 3) -Location: Jim Wells County (Wade City Field Prospect), Frio Formation
-Depth: 5,500'
-Potential Reserves: 3.72 MMBO & 1.8 BCFG
- 4) -Location: Fayette County (Cistern Field Prospect), Wilcox (Carrizo)
-Depth: 3,000'
-Potential Reserves: 600,000 BO
- 5) 45 Well South Texas production package for sale.

Operator

Cimarron Engineering – James Geryk P.E. (Kingsville, TX)

See executive summary for more details, for prospect file please email Jay@tjmcgovern.com
or call Jay McGovern at 1-361-537-2394. No CA needed.

Thanks,

J.V. McGovern P.G. #1170



JAY V. MCGOVERN

CERTIFIED PETROLEUM GEOLOGIST No. 1170

4226 Petronila Creek, Corpus Christi, TX 78410

Mobile: (361)537-2394 Email: jay@tjmcgovern.com

Scott Leaseburge – Mobile: (832)217-5649 Email: scottleaseburge@gmail.com

West Berkow Field Prospect Executive Summary

1. Location: Bee County
2. Field: West Berkow
3. Acreage: 150 acre, Kenneth McDonald 18-month Lease, 75% NRI Lease
4. Formation: Frio Sands
5. Depth: 5,500' TD
6. 5 Potential Targets
7. Type of Trap: Up-to-the-Coast Fault & Stratigraphy
8. Supported by Subsurface Geology & Core Tests
9. Estimated Number of Wells: 4
10. Potential Reserves: 4,200,000 BO & 1.5 BCFG
11. Approx. Cost of 1%: \$6,930

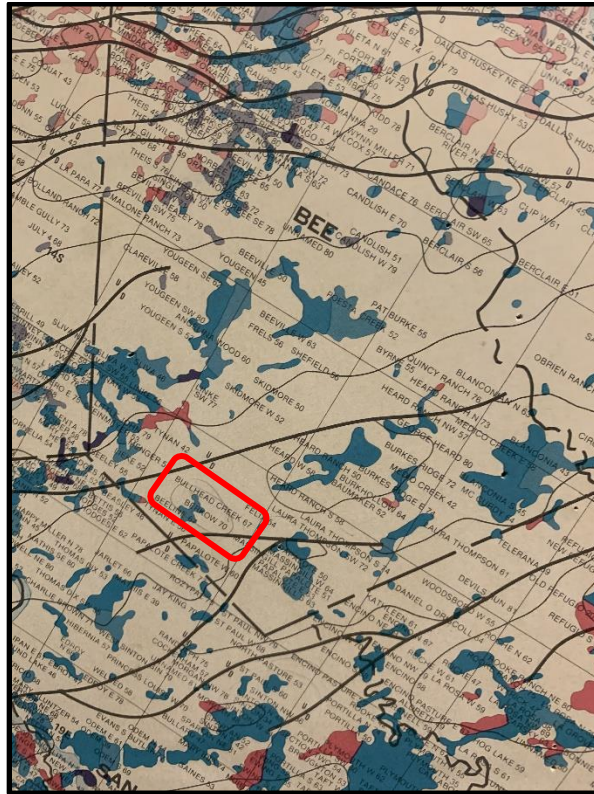

*This prospect is subject to prior sale without notice and can be withdrawn at any time.

JAY V. MCGOVERN

CERTIFIED PETROLEUM GEOLOGIST No. 1170

4226 Petronila Creek, Corpus Christi, TX 78410

Mobile: (361)537-2394 Email: jay@tjmcgovern.com

Symphony Ovalles – Mobile: (210) 364-1470 Email: symphonyovalles.geo@gmail.com

Melissa Peña – Mobile: (210)279-8790 Email: melissapenageo@gmail.com

Tynan Field Prospect Executive Summary

1. Location: Bee County, Texas (1-hour North of Corpus Christi)
2. Field: Tynan Field
3. Acreage: 150 acres, James McDonald 18-month Lease, 75% NRI Lease
4. Formation: Frio Sands
5. Depth: 4,750' TD
6. 8 Potential Targets
7. Type of Trap: Stratigraphic & Structural
8. Supported by Subsurface Geology & Core Tests
9. Estimated Number of Wells: 6
10. Potential Reserves: 2,200,000 BO & 4.5 BCFG
11. Approx. Cost of 1%: \$6,460

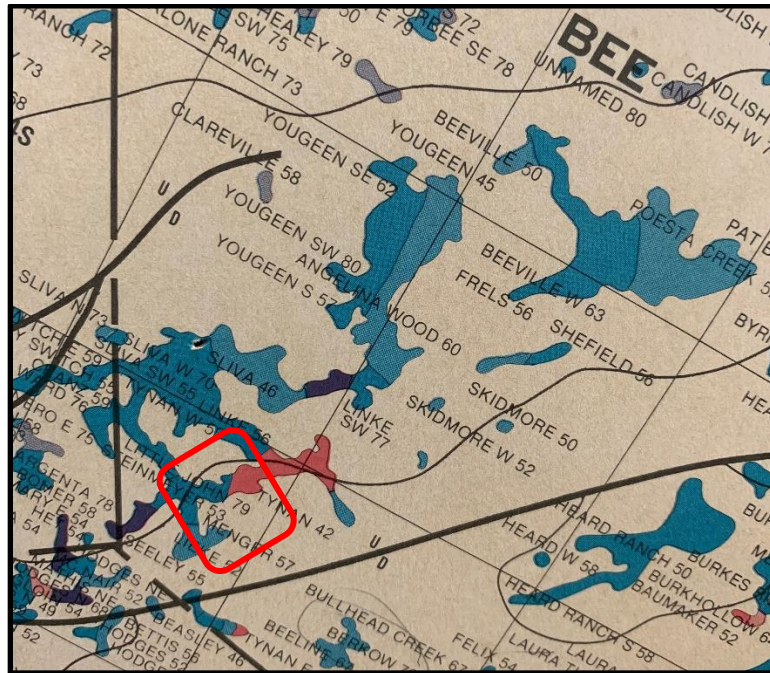

*This prospect is subject to prior sale without notice and can be withdrawn at any time.

JAY V. MCGOVERN

CERTIFIED PETROLEUM GEOLOGIST No. 1170

4226 Petronila Creek, Corpus Christi, TX 78410

Mobile: (361)537-2394 Email: jay@tjmcgovern.com

Melissa Peña – Mobile: (210)279-8790 Email: melissapenageo@gmail.com

Wade City Field Prospect Executive Summary

1. Location: Jim Wells County, Texas (1-mile North of Orange Grove Texas & 18 miles West of Corpus Christi, Texas)
2. Field: Wade City
3. Acreage: 137.41, Havelka-Legan Warren Properties, 18-month Lease, 75% NRI Lease
4. Formation: Frio Sands
5. Depth: 5,500' TD
6. 10 Potential Targets
7. Type of Trap: Anticline
8. Supported by Subsurface Geology & Core Tests
9. Estimated Number of Wells: 3
10. Potential Reserves: 3,720,000 BO & 1.8 BCFG
11. Approx. Cost of 1%: \$6,950

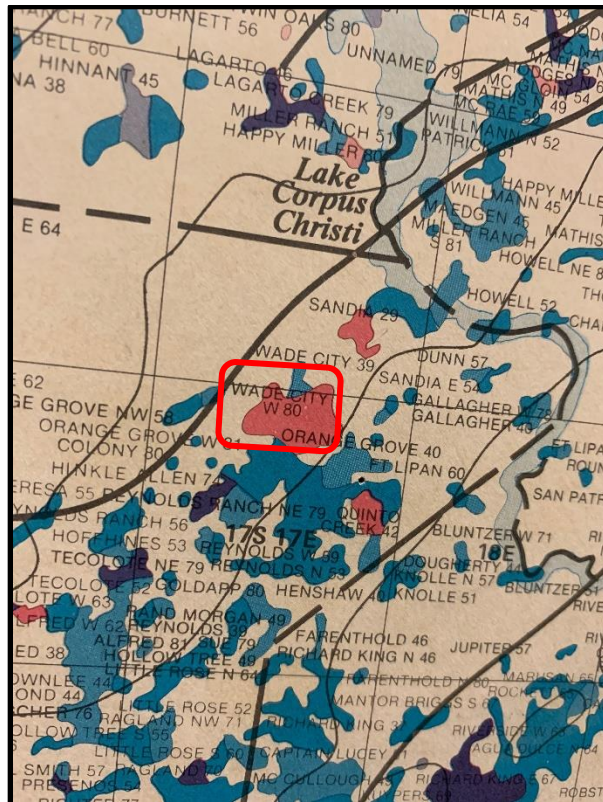

*This prospect is subject to prior sale without notice and can be withdrawn at any time.

JAY V. MCGOVERN

CERTIFIED PETROLEUM GEOLOGIST No. 1170

4226 Petronila Creek, Corpus Christi, TX 78410

Mobile: (361)537-2394 Email: jay@tjmcgovern.com

Tanner Bowersox – Mobile: (717)-688-0270 Email: TannerBowersox22@gmail.com

Cistern Field Prospect Executive Summary

1. Location: Fayette County, Texas
2. Field: Cistern
3. Acreage: 65 acre, 18-month Lease, 75% NRI Lease
4. Formation: Wilcox (Carrizo)
5. Depth: 3,000' TD
6. 6 Potential Targets
7. Type of Trap: Up-to-the-Coast Fault & Stratigraphy
8. Supported by Subsurface Geology & Core Tests
9. Estimated Number of Wells: 3
10. Potential Reserves: 600,000 BO
11. Approx. Cost of 1%: \$4,350

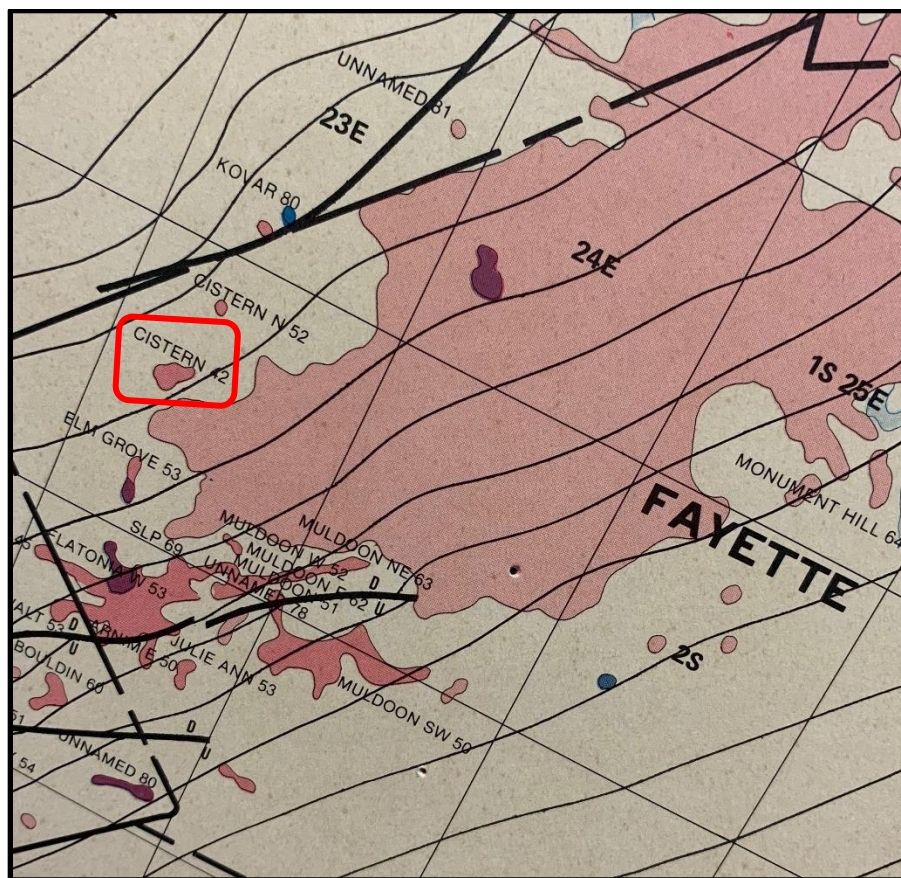

*This prospect is subject to prior sale without notice and can be withdrawn at any time.